

ENTREMAT^{IC}

C-CLASS™ COMMERCIAL HVLS FAN

PRODUCT SPECIFICATIONS

HIGH VOLUME LOW SPEED FAN



Design Highlights

- Optimized 5-Blade profile for low speed rotary airfoil application and near ground effect
- Wired Touch Screen or Wireless Controls Standard
- Reverse capability
- Capability to shut down with the fire system
- Suitable for ceilings as low as 12 feet (3.7m)
- Less than 35 dBA*
- ETL to UL 507 certification
- Easy customization of fan to fit customers applications (powder coating options)
- Light weight
- Energy efficient
- Patent-pending design includes unique winglet and innovative snap on blade attachment

*Results of sound measurement in the field may vary due to variations in surface types, environment and conditions.

**A button on the controls module must be switched in order to switch the wireless controls to reverse.

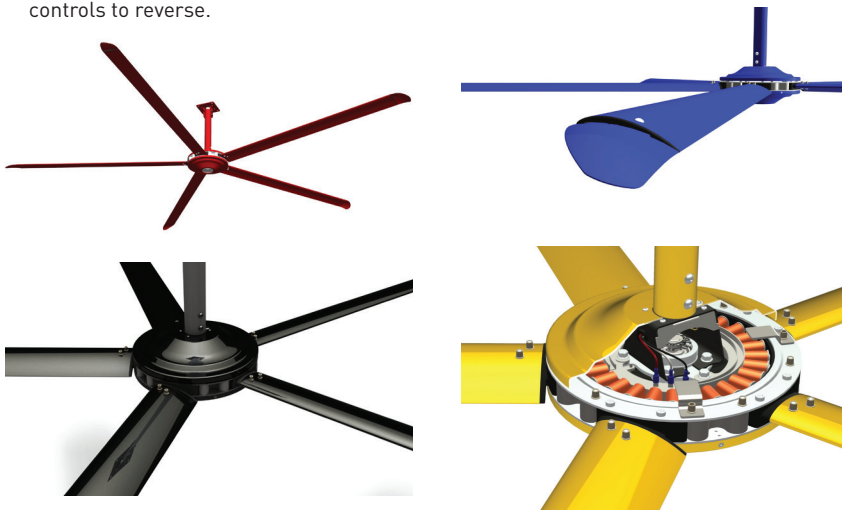

Fan Diameter

- 6 FT (1.8 M)
- 8 FT (2.4 M)
- 10 FT (3.0 M)
- 12 FT (3.7 M)
- 14 FT (4.3 M)

Standard Configurable Colors

- Stardust Silver _____ RAL 9006
- Gloss Black _____ RAL 9017
- Reflective White _____ RAL 9003
- Red Baron _____ RAL 3002
- Cobalt Blue _____ RAL 5013
- Safety Green _____ RAL 6016
- Safety Orange _____ RAL 2004
- Safety Yellow _____ RAL 1018
- Custom Color(s) _____

Available colors are approximate match to global RAL color chart. Available colors can be mixed and matched. For additional information Consult Factory.

If not selected, default color shipped is all silver with black winglets (as shown above).

Available Options

- Mounting Down Tube _____ ft.
Standard down tube 18 in.
- Networked Multi-Fan Controller
- Modbus (BMS)
- BACnet (BMS)

Project Information

Job Name _____
 Address _____
 General Contractor _____
 Distributor _____
 Model _____ Quantity _____

Certified For Construction

By _____
 Company _____
 Address _____
 Date _____

C-CLASS™ COMMERCIAL HVLS FAN

PRODUCT SPECIFICATIONS

HIGH VOLUME LOW SPEED FAN

CONSTRUCTION	General Components	
	Hub Assembly	50,000 lbs. Yield High Tensile Steel
	Motor Housing	.050 3003 Aluminum, Powder coated
	Blades	6063-T6 Aluminum, Powder coated
	Blade End Winglets	6061-T6 Aluminum, Powder coated
	Safety Components	
	Blade Attachment Retainers	50,000 lbs Yield High Tensile Steel
	Mounting Hardware	
	Standard Mount	Versatile 45° Mounting Bracket
	Additional Drop Extensions (Optional)	Up to 15 FT - 1 FT increments

OPERATION	Source Voltage	
	Standard Power	120V - 230V 1Ø
	Motor	
	Gearless Direct Drive Motor (AC)	
	Controls Module	
	Remote	
	Enclosure NEMA 1	
	UL Certified	
	Fan Controller	
	Touch Screen / Wireless	
Warranty		
10 Year Parts, 1 Year Labor		

Fan Size	Energy Used	Motor	Hang Weight	RPM
6 FT	250W	400W	50 lbs [22.7 kg]	200
8 FT	250W	400W	54.5 lbs [24.7 kg]	165
10 FT	250W	400W	59 lbs [26.8 kg]	110
12 FT	250W	400W	63 lbs [28.6 kg]	80
14 FT	250W	400W	65 lbs [29.5 kg]	60

Energy used and RPM shown above based on max speed.

NOTICE

For more complete information on the application, proper use, maintenance and warranties for this product, please go to www.entrematicfans.com.

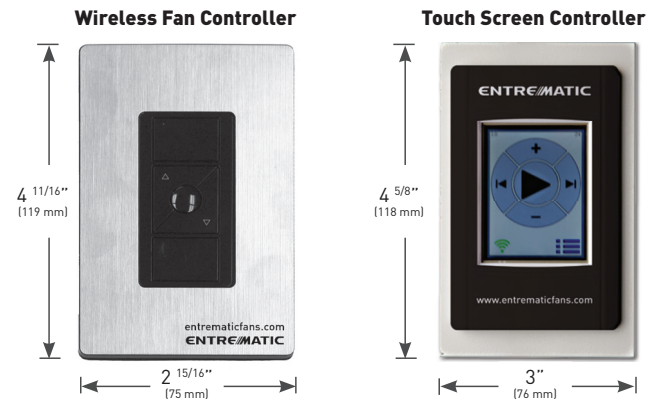

NACA optimized blade profile provides high lift, low drag coefficients at low velocities equating to a highly efficient profile for low speed rotary airfoils.

